

# BAVARIA CRUISER 40

Sylvia (2013)



**PRIMA SAILING**  
charter agency

VEMSA D.O.O. • Ozka Ulica 7 • 2310 Slovenska Bistrica • Slovenia

Phone: +386 41 767 155

E-mail: [booking@prima-sailing.com](mailto:booking@prima-sailing.com)

Web: [prima-sailing.com](http://prima-sailing.com)

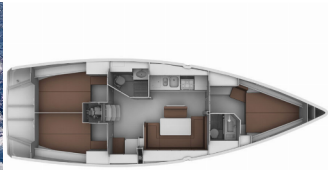

|                      |                            |
|----------------------|----------------------------|
| <b>Charter Base</b>  | Preveza, Main Port, Greece |
| <b>Yacht ID</b>      | 8371                       |
| <b>Charter Brand</b> | Bavaria Yachtbau           |
| <b>Name</b>          | Sylvia                     |
| <b>Year</b>          | 2013                       |
| <b>Length</b>        | 12.35 M                    |
| <b>Cabins</b>        | 3                          |
| <b>Berths</b>        | 6 + 1                      |
| <b>Head/Shower</b>   | 2                          |

**DECK:** Bimini top, Electric anchor windlass, Gangway, Hydraulic lifting swimming platform, Mooring ropes , Repair box for dinghy, Reserve motor oil, Sprayhood

**ENTERTAINMENT:** Radio CD mp3 player

**INTERIOR:** Electric fans in cabins, Electric toilet

**NAVIGATION:** Autopilot, Bow thruster, Echosounder/Depthsounder, GPS chart plotter - cockpit, Speedometer (Speed log), Wind instrument/Anemometer

**SAFETY:** Repair kit, VHF radio

**YACHT ELECTRICS:** Inverter, Service batteries, Solar panels, Start battery

## AVAILABILITY & PRICES

Bavaria Cruiser 40 Sylvia (2013)



**PRIMA SAILING**

charter agency

|   |   |   |   |
|---|---|---|---|
| <b>21.09. - 28.09.2024</b><br>1.843 € <del>3.350€</del> | <b>28.09. - 05.10.2024</b><br>1.843 € <del>3.350€</del> | <b>05.10. - 12.10.2024</b><br>1.838 € <del>2.450€</del> | <b>12.10. - 19.10.2024</b><br>1.838 € <del>2.450€</del> |
| <b>19.10. - 26.10.2024</b><br>1.610 € <del>1.850€</del> | <b>26.10. - 02.11.2024</b><br>1.610 € <del>1.850€</del> | <b>02.11. - 09.11.2024</b><br>1.610 € <del>1.850€</del> | <b>09.11. - 16.11.2024</b><br>1.610 € <del>1.850€</del> |
| <b>16.11. - 23.11.2024</b><br>1.610 € <del>1.850€</del> | <b>24.11. - 31.12.2024</b><br>Booked                    | <b>01.01. - 04.04.2025</b><br>Booked                    | <b>05.04. - 12.04.2025</b><br>1.573 € <del>1.850€</del> |
| <b>12.04. - 19.04.2025</b><br>1.573 € <del>1.850€</del> | <b>19.04. - 26.04.2025</b><br>1.573 € <del>1.850€</del> | <b>26.04. - 03.05.2025</b><br>1.955 € <del>2.300€</del> |   |

## AVAILABILITY & PRICES

Bavaria Cruiser 40 Sylvia (2013)



**PRIMA SAILING**

charter agency

|   |   |   |   |
|---|---|---|---|
| <b>03.05. - 10.05.2025</b><br>1.955 € <del>2.300€</del> | <b>10.05. - 17.05.2025</b><br>1.955 € <del>2.300€</del> | <b>17.05. - 24.05.2025</b><br>1.955 € <del>2.300€</del> | <b>24.05. - 31.05.2025</b><br>2.380 € <del>2.800€</del> |
| <b>31.05. - 07.06.2025</b><br>2.380 € <del>2.800€</del> | <b>07.06. - 14.06.2025</b><br>2.380 € <del>2.800€</del> | <b>14.06. - 21.06.2025</b><br>2.380 € <del>2.800€</del> | <b>21.06. - 28.06.2025</b><br>2.380 € <del>2.800€</del> |
| <b>28.06. - 05.07.2025</b><br>2.380 € <del>2.800€</del> | <b>05.07. - 12.07.2025</b><br>2.848 € <del>3.350€</del> | <b>12.07. - 19.07.2025</b><br>2.848 € <del>3.350€</del> | <b>19.07. - 26.07.2025</b><br>2.848 € <del>3.350€</del> |
| <b>26.07. - 02.08.2025</b><br>2.848 € <del>3.350€</del> | <b>02.08. - 09.08.2025</b><br>3.273 € <del>3.850€</del> | <b>09.08. - 16.08.2025</b><br>3.273 € <del>3.850€</del> | <b>16.08. - 23.08.2025</b><br>3.273 € <del>3.850€</del> |
| <b>23.08. - 30.08.2025</b><br>2.848 € <del>3.350€</del> | <b>30.08. - 06.09.2025</b><br>2.848 € <del>3.350€</del> | <b>06.09. - 13.09.2025</b><br>2.848 € <del>3.350€</del> | <b>13.09. - 20.09.2025</b><br>2.848 € <del>3.350€</del> |
| <b>20.09. - 27.09.2025</b><br>2.848 € <del>3.350€</del> | <b>27.09. - 04.10.2025</b><br>2.848 € <del>3.350€</del> | <b>04.10. - 11.10.2025</b><br>2.083 € <del>2.450€</del> | <b>11.10. - 18.10.2025</b><br>2.083 € <del>2.450€</del> |
| <b>18.10. - 25.10.2025</b><br>1.573 € <del>1.850€</del> | <b>25.10. - 01.11.2025</b><br>1.573 € <del>1.850€</del> | <b>01.11. - 08.11.2025</b><br>1.573 € <del>1.850€</del> |   |